



# INSTRUCTION BULLETIN

No. 340461  
Machine: 5680  
Published: 1-01/00  
System: ELECTRICAL

**NOTE: DO NOT DISCARD the Parts List from the Instruction Bulletin. Place the Parts List in the appropriate place in your machine manual for future reference. Retaining the Parts List will make it easier to reorder individual parts and will save you the cost of ordering an entire kit.**

*NOTE: Numbers in parenthesis ( ) are reference numbers for parts listed in Bill of Materials.*

Installation instructions for kit number 368591

## **SYNOPSIS / PROBLEM:**

This kit contains the parts needed to replace the control panel shroud on the model 5680 scrubber.

Please follow step-by-step instructions.

## **SPECIAL TOOLS / CONSIDERATIONS: NONE**

(Estimated time to complete: 2 hours)

## **PREPARATION:**

(Refer to FIG. 1 and 2)

**FOR SAFETY: Before leaving or servicing machine, stop on level surface and set parking brake. Then turn off machine and remove key.**

1. Disconnect battery cables from machine.



**WARNING: Always disconnect battery cables from machine before working on electrical components.**

## **SHROUD REMOVAL:**

(Refer to FIG. 1)

1. Make sure the solution tank is empty. Raise the solution tank and engage the safety arm.

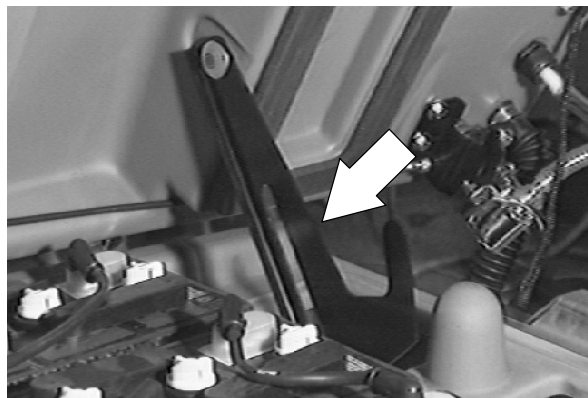

*NOTE: Disconnect the negative battery cable from the battery nearest the back of the machine before servicing any electrical components.*

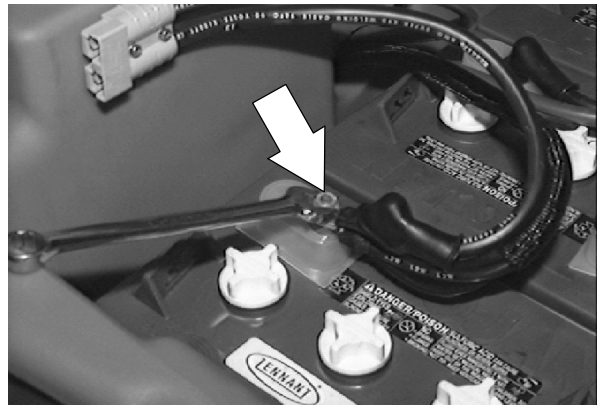

2. Lower the squeegee to the floor. Lift the solution and recovery tank drain hoses off of their hose clips. Remove the M8 hex screws holding the rear electrical panel to the electrical mounting plate. (Refer to FIG. 1)

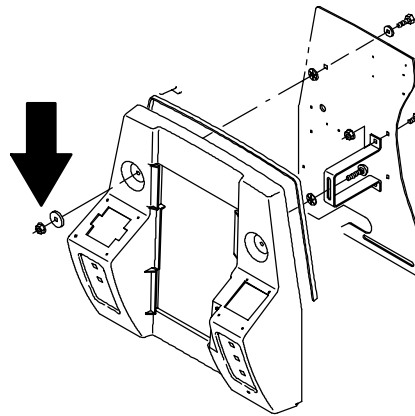

3. Tilt the instrument panel assembly back until it is resting against the lanyard strap.

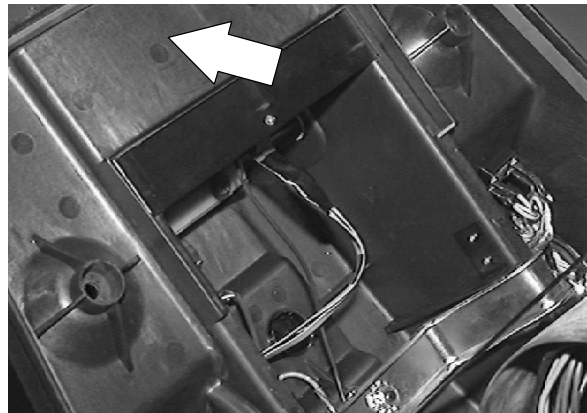

4. All of the electrical components that are contained in the instrument panel and on the electrical mount panel, can now be easily accessed. Label all accessory wires before disconnecting from accessories mounted in the shroud. Cut and remove the plastic wire ties that are holding the potentiometer wire to the main panel harness.

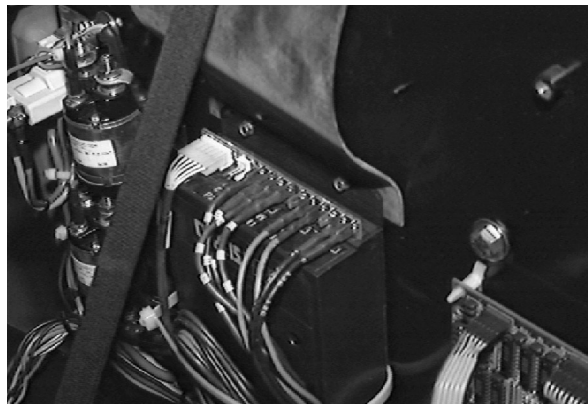

5. Unplug the potentiometer from the controller. Unplug the wire harness from the stop switch. Loosen the speed control handle latch, and remove the shroud locking bracket from behind the shroud. Set the locking bracket aside. Slide the adjustable steering housing out of the slots in the fixed steering housing. (Refer to FIG. 1)

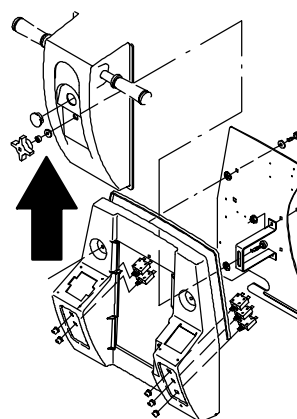

6. Disconnect, remove and set aside the hourmeter, battery discharge indicator and circuit breakers from the left hand side of the shroud. (Refer to FIG. 1)

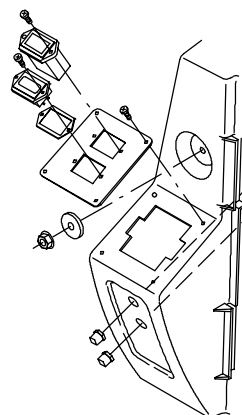

7. Disconnect, remove, and set aside the on/off key switch, scrub switch, and circuit breakers from the right hand side of the shroud. (Refer to FIG. 1)

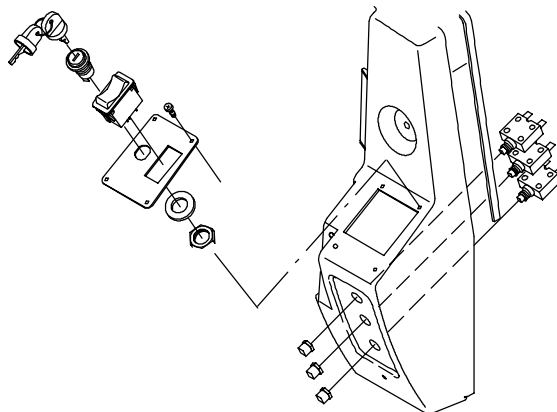

8. Remove the hex screw and nut holding the squeegee lift handle to the fixed steering housing. Let the handle drop down off the housing. Set the handle aside. (Refer to FIG. 1)

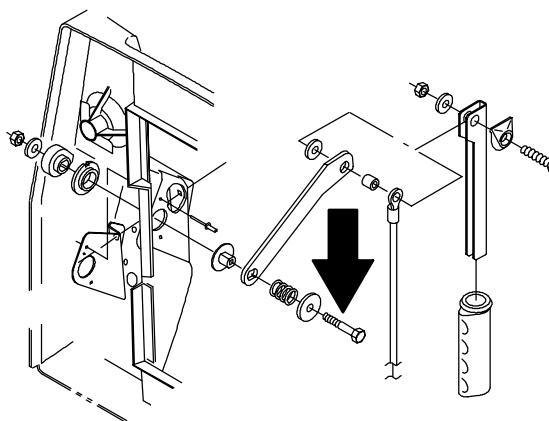

9. Disconnect the housing from the lanyard strap. Remove and discard the fixed steering housing. (Refer to FIG. 1)

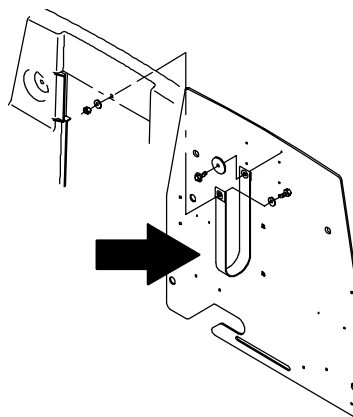

## NEW SHROUD INSTALLATION:

1. Mount the new rubber seal (3) along the outside edge of the new housing (1).

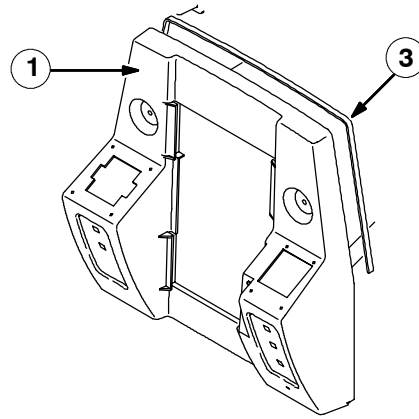

2. Install the new housing on the machine. Connect the lanyard strap to the new housing (1). Leave the new housing (1) tilted open to access the wire harness connections for instruments.

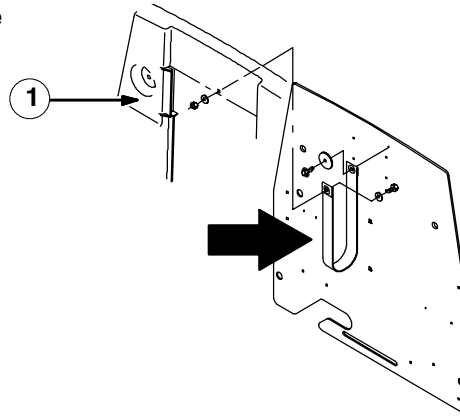

3. Remove the fan switch and mounting hardware from the old housing. Mount the fan switch to the new fan switch bracket (10) with mounting hardware.

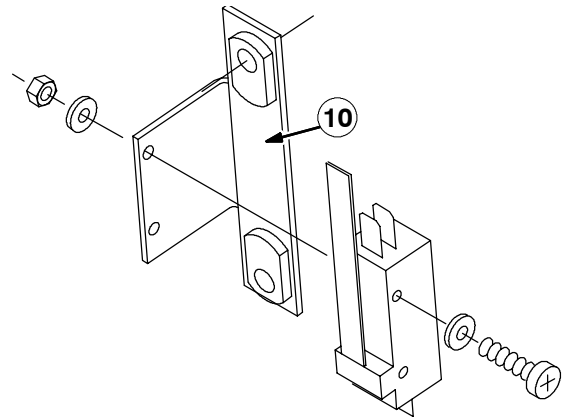

4. Mount the new switch bracket (10), squeegee pivot plate (14), and catch bracket (7) with hex screw (13), and mounting hardware from the old housing. Secure the side of the squeegee pivot plate (14) with the two rivets (15).

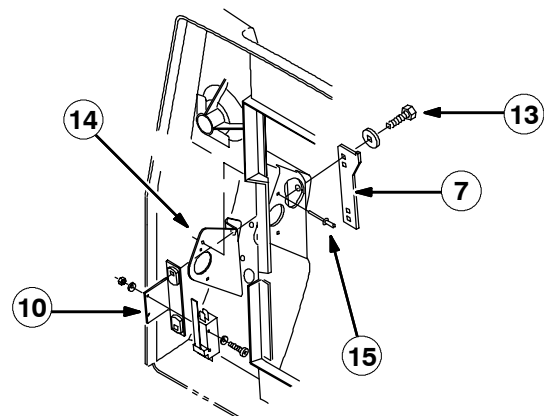

5. Reinstall the squeegee lift handle to the new housing (1). Install the squeegee lift handle assembly with the new pivot (12) and flange bushing (11).

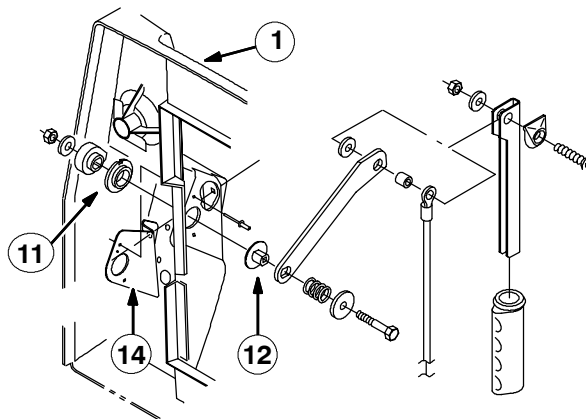

6. Install and reconnect the on/off key switch, scrub switch, and circuit breakers in the right hand side of the new shroud (1).

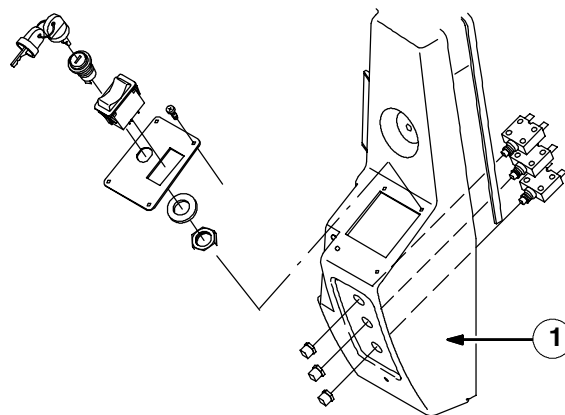

7. Install and reconnect the hourmeter, battery discharge indicator and circuit breakers on the left hand side of the shroud (1).

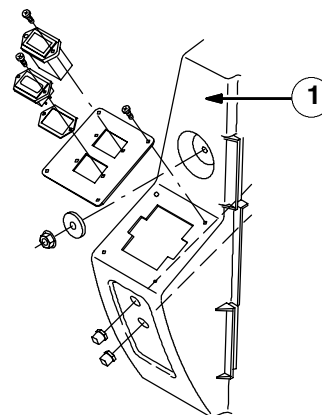

8. Locate the old shroud locking bracket behind the new shroud (1). Replace the old shroud locking bracket with the new locking bracket (2).

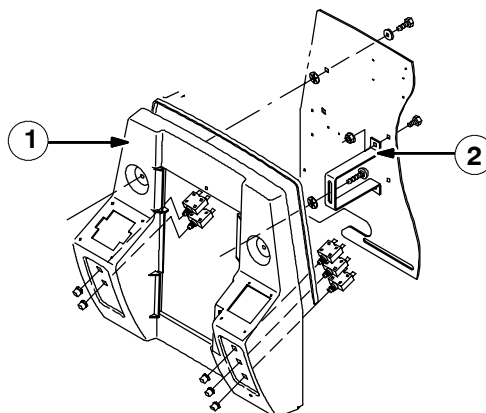

9. Slide the adjustable steering housing into the slots in the new housing (1). Reinstall the shroud adjustment knob and connect to the new locking bracket. Tighten the knob to secure the adjustable housing. Reconnect the stop switch to the wire harness. Reconnect the potentiometer to the controller. Secure the potentiometer wire to the main panel harness with the plastic wire ties (4).

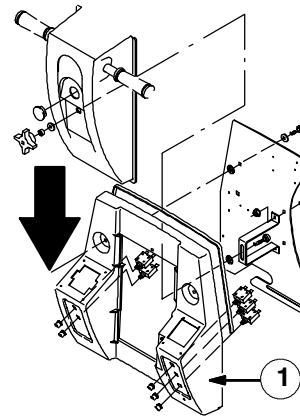

10. Install the two new hose hanger clips to the left hand side of the new housing (1) with hex screws (17), flat washers (18) and lock nuts (19). Hang the recovery and solution tank drain hoses back up on the hose hanger clips.

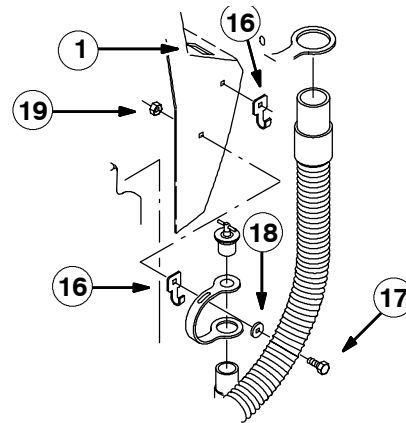

11. Tilt the housing assembly back into the closed position. Secure the panel with the set aside mounting hardware. Raise the squeegee with the squeegee lift lever. Secure the squeegee lift handle in the new catch bracket (7).

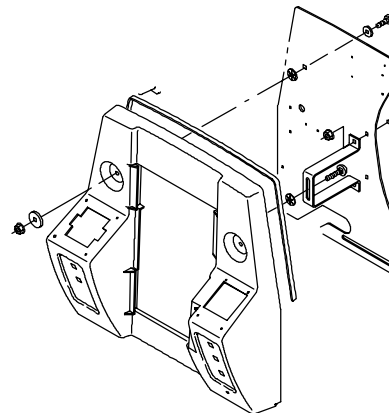

12. Reconnect the battery cables to the machine. Lower the solution tank. Turn the machine power on, and check all the instruments on the control panel for proper operation.

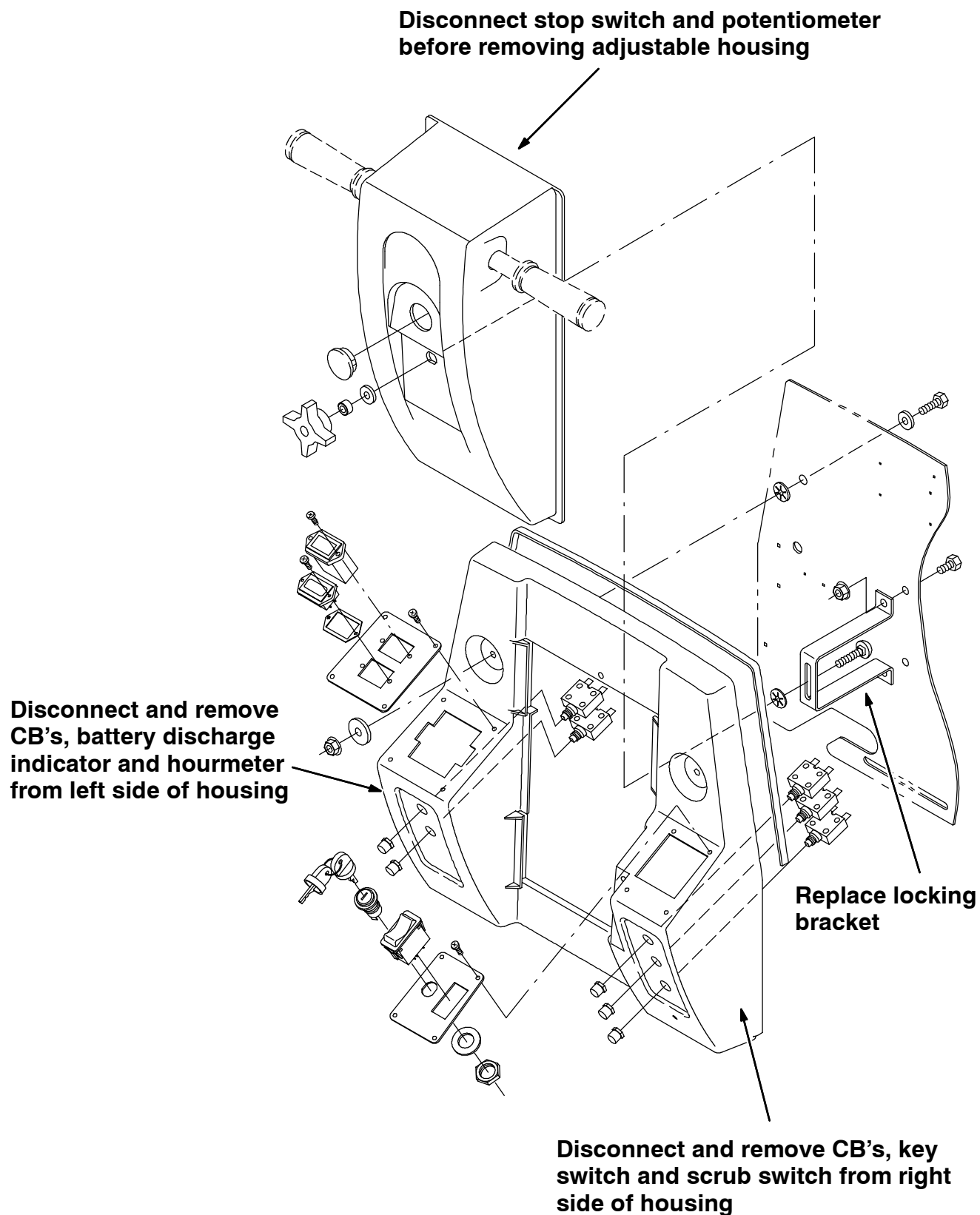

**FIG. 1 - OLD SHROUD BREAKDOWN**



**BILL OF MATERIALS FOR 5680 SHROUD REPLACEMENT KIT 368591**

<b>Ref.</b>	<b>TENNANT Part No.</b>	<b>Description</b>	<b>Qty.</b>
1	397712	Panel, inst, mold and trim	1
2	222747	Bracket, locking, shrd	1
3	222639	Seal, rbr, clsd, 0.13th, 0.38W, 36.0L	1
4	49266	Tie, cable, nyl, 07.3L 0.19W 1.8 Max D	5
5	222666	Clamp, cable, ribbon, 1.25W 0.25H plstc	2
6	222533	Label set, opertnl	1
7	222138	Bracket, catch	1
8	32166	Bag, shipping	1
9	45727-1	Carton, fol	1
10	222402	Bracket, switch, fan	1
11	222868	Bushing, flange, 0.75B 1.0D 0.28L	1
12	222871	Pivot	2
13	11329	Screw, hex, M06 X 1.0 X 16, Ss, NI	1
14	222867	Plate, sqge, pivot	1
15	34738	Rivet, blind, 0.125D X 0.32 X 0.25D, stl	2
16	222793	Clip, hanger, hose	2
17	15675	Screw, hex, M08 X 1.25 X 16, Ss	2
18	01685	Washer, flt, 0.31 Ss	2
19	08713	Nut, hex, lock, M08 X 1.25, NL, Ss	2

TENNANT COMPANY  
P. O. Box 1452  
Minneapolis, MN 55440-1452